

## Global Service Network-Overseas Area

### IFE Elevators & Escalators (Russia)

Tel: +7(926)-894-81-96 Email: ru@ifelift.com  
Address: SK Plaza, Dmitrovskoe Road 163ak2, Moscow, Russia

### M/s IFE MIDDLE EAST ELEVATORS LLC

Tel: +971(0)42505888 Email: ae@ifelift.com  
Address: 502# Sapphire Tower, Ittihad Road ,Deira Dubai, UAE

### IFE Elevators & Escalators (Australia) Pty Ltd

Tel: +61(0)8 9202 4666 Email: au@ifelift.com  
Address: 36 Beringarra Avenue Malaga WA 6090

### PT.IFE ELEVATORS INDONESIA

Tel: +62 21 22604802 Email: ifeindo@ifelift.com  
Address: The Mansion Dukuh Golf Kemayoran Tower Fontana Lt.21 Unit L2 & m2,  
JI Trembesi Blok D4 Pademangan Timur Pademangan Jakarta Utara Dki Jakarta 14410

### IFE ELEVATORS LANKA

Tel: +94112686867 Email: SI@ifelift.com  
Address: 158/9 Lake Drive colombo 08 Sri lanka

### Office in Singapore

Tel: +86 13929229955  
Address: 23 Genting Road #07-01/02 Chevalier House Singapore 349481



### IFE ELEVATORS CO.,LTD

China Factory: Qingxi Town, Dongguan City, Guangdong  
Tel: +86-769-82078888 Fax: +86-769-87732448  
Hotline: 400-6789-443 Website: www.ife.cn

The image and content are just for you reference and please be subject to the actual products. Please pardon us for not informing you in advance if anything updated.  
Please contact IFE for details.

202101 © All Rights Reserved @ IFE

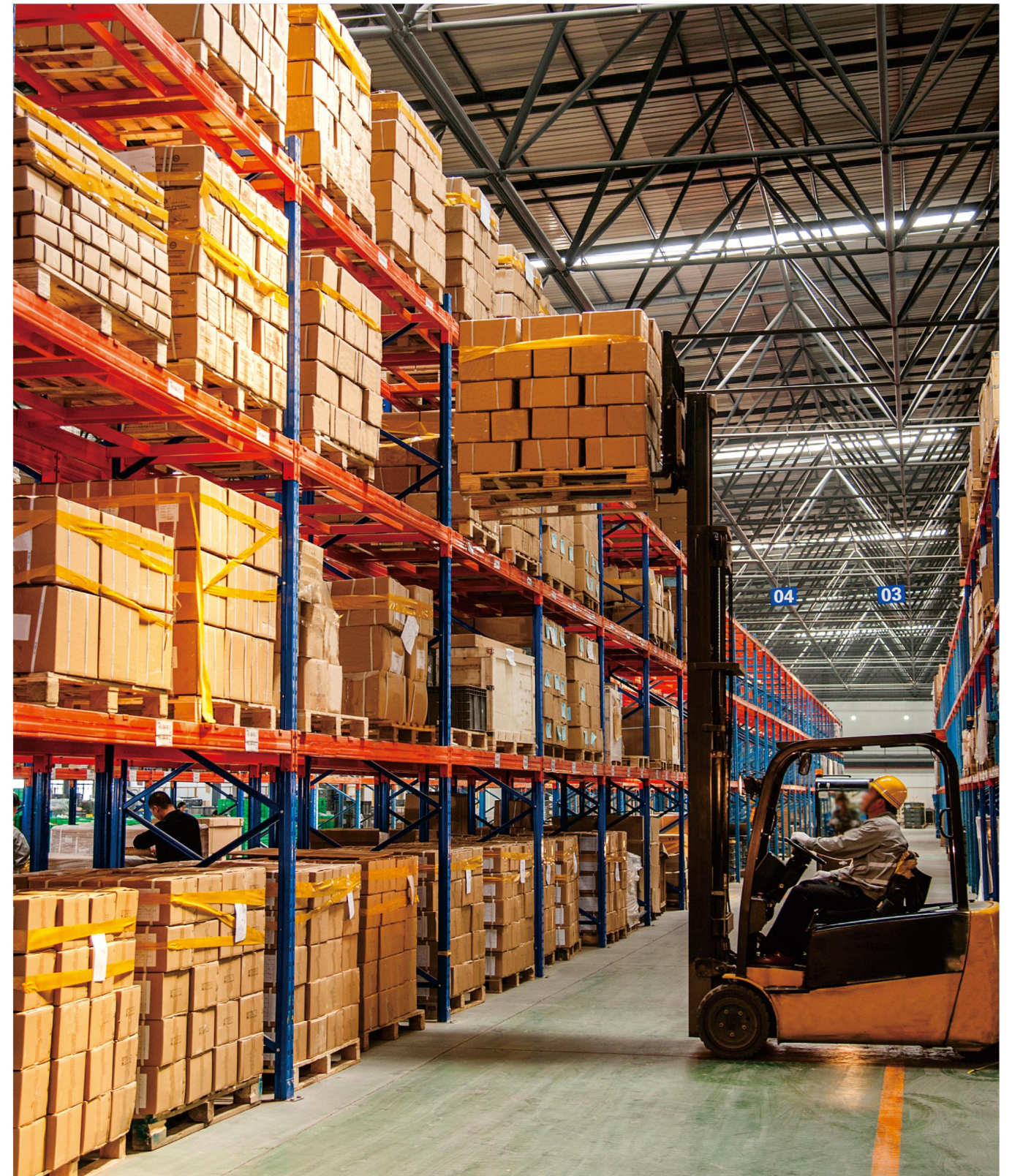

## ATLAS / FPA Cargo Elevator/Automobile Elevator Series

Trusted by the World  
Stock code: 002774







## LEADING IN EXPORT VALUE AMONG CHINESE ELEVATOR BRANDS FOR LAST 6 YEARS

- China National Elevator Brand A Share Listed Enterprises (Stock Code: 002774)
- It is one of the first batch of elevator enterprises that have obtained the qualification of manufacturing grade A, installing grade A, transforming grade A and maintaining grade A issued by China's general administration of quality supervision, inspection and quarantine
- IFE has an industrial production base of 110,000 square meters. In addition, there are international leading elevator and escalator double test tower
- National high-tech enterprises and provincial elevator r & d center
- IFE products are sold in 33 countries and regions on 5 continents
- There are more than 100 branch companies and service outlets in the world
- It covers more than 300 cities above prefecture level in China and radiates more than 2000 administrative regions at County level
- More than 1000 after-sales and engineering technicians



# CLASSIC CASE



Lixun Precision Co., Ltd.



Gardobo Beverage Food Co., Ltd.



Omron Precision Electronics



Mingmen (China) Kindergarten Products Co., Ltd.



Meiyingsen Group Co., Ltd.



Jiuzhou Tong Pharmaceutical Group Co., Ltd.



Hui Ke group

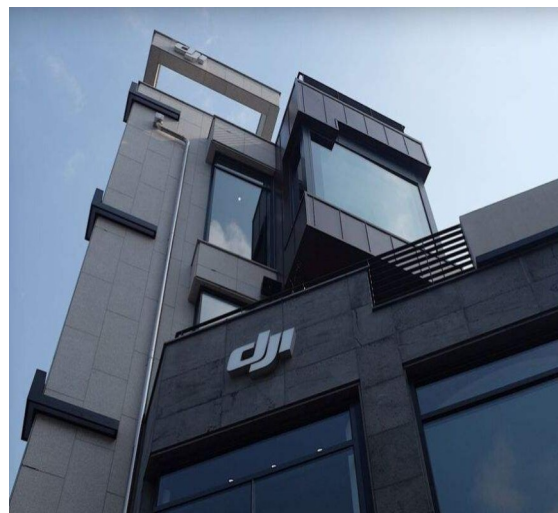

Dajiang Innovation Technology Co., Ltd.



Jingdong group



Huizhou Huaye Shengshi Investment Co., Ltd.



Suning Yunshang Group Co., Ltd.

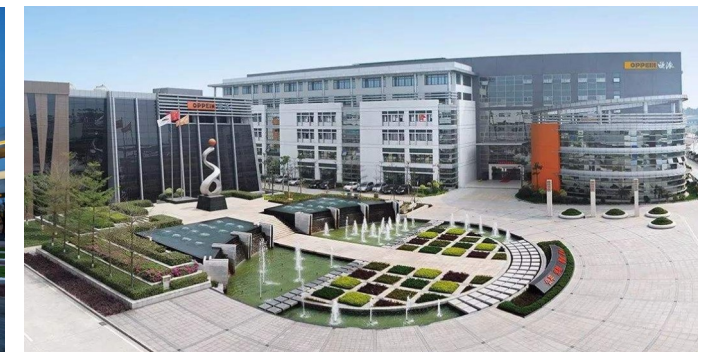

Europa Smart Home

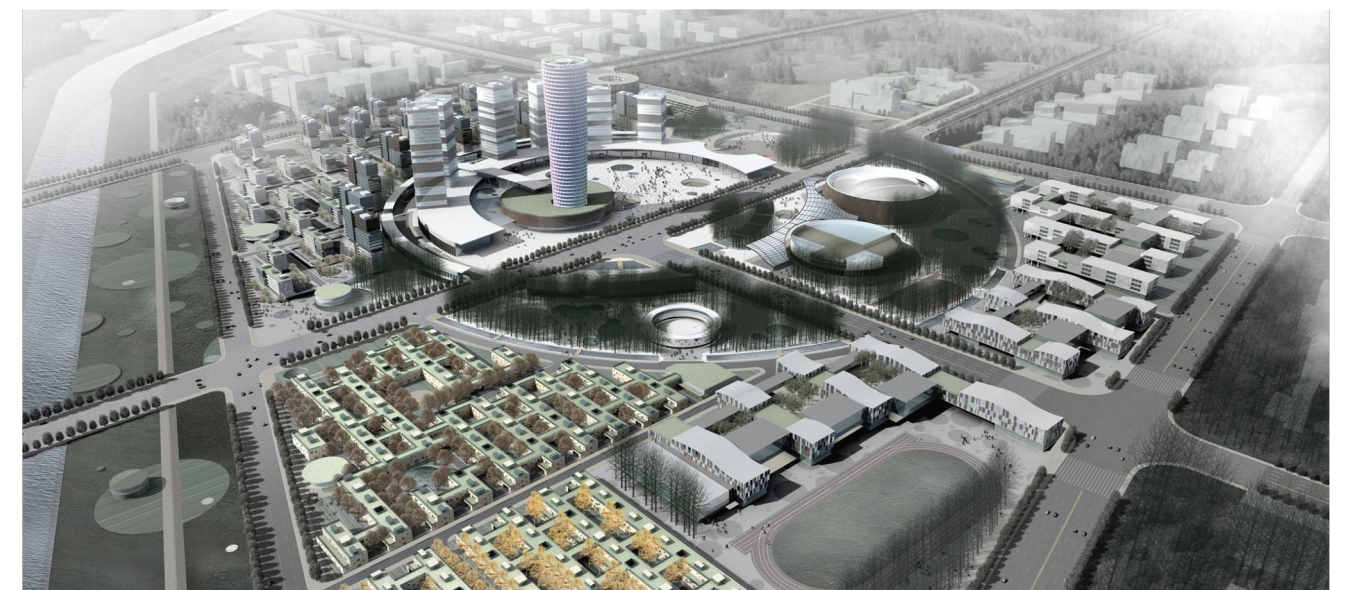

Foxconn Technology Group



# SAFE AND RELIABLE

## Real-time detection to protect the safety of people and objects

- ◆ The brake detection device detects the state of the brake in real time throughout the whole process, actively reports the brake fault detection when abnormal, eliminates the risk of brake failure, and protects the safety of people and objects.

## Photoelectric Induction Protection Device

- ◆ The non-contact protection device forms a dense infrared cross light curtain, which can effectively prevent the elevator door from injuring passengers or the forklift from damaging the elevator door when loading and unloading goods.

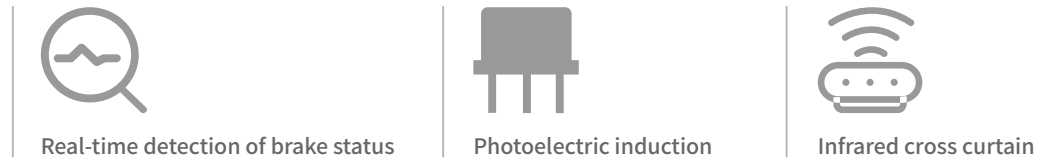

## Leading Rope Anti-loosening Detection Device

Patent No. ZL201420470694.0

- ◆ The anti-loosening detection device of the towing rope detects the whole process in real time. When the towing rope relaxes, the elevator will stop running immediately to ensure the safety of the elevator.

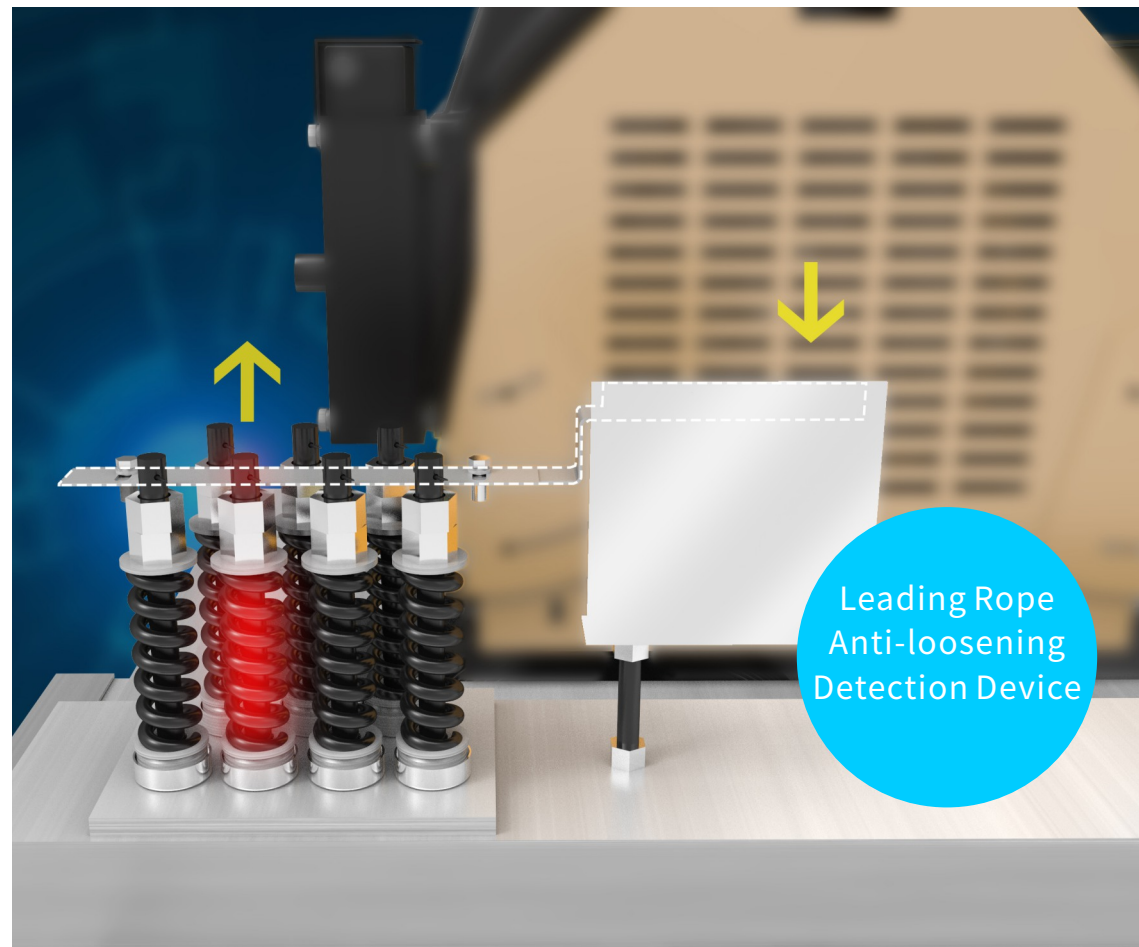

## Open the Door and Lay It Flat

- ◆ When the elevator stops and opens the door, it is found that the difference between the car and the floor door is larger than the prescribed value. The elevator automatically operates to make the floor of the car and floor door again flat.

## Reciprocal Device for Switching Door (Optional)

- ◆ The elevator opens and waits, and countdown closes (the countdown time can be set).

## EMS Elevator Management System (Optional)

- ◆ The elevator management system of the monitoring center can control the operation of the freight elevator and the door remotely and intelligently, so as to realize the central dispatch without additional driver for the elevator.

## Industry Leading Whole-Course Weighing Technology

Patent No. ZL201410337015.7

- ◆ Accurately measure the car load of each floor station to avoid potential safety hazards caused by overloading.

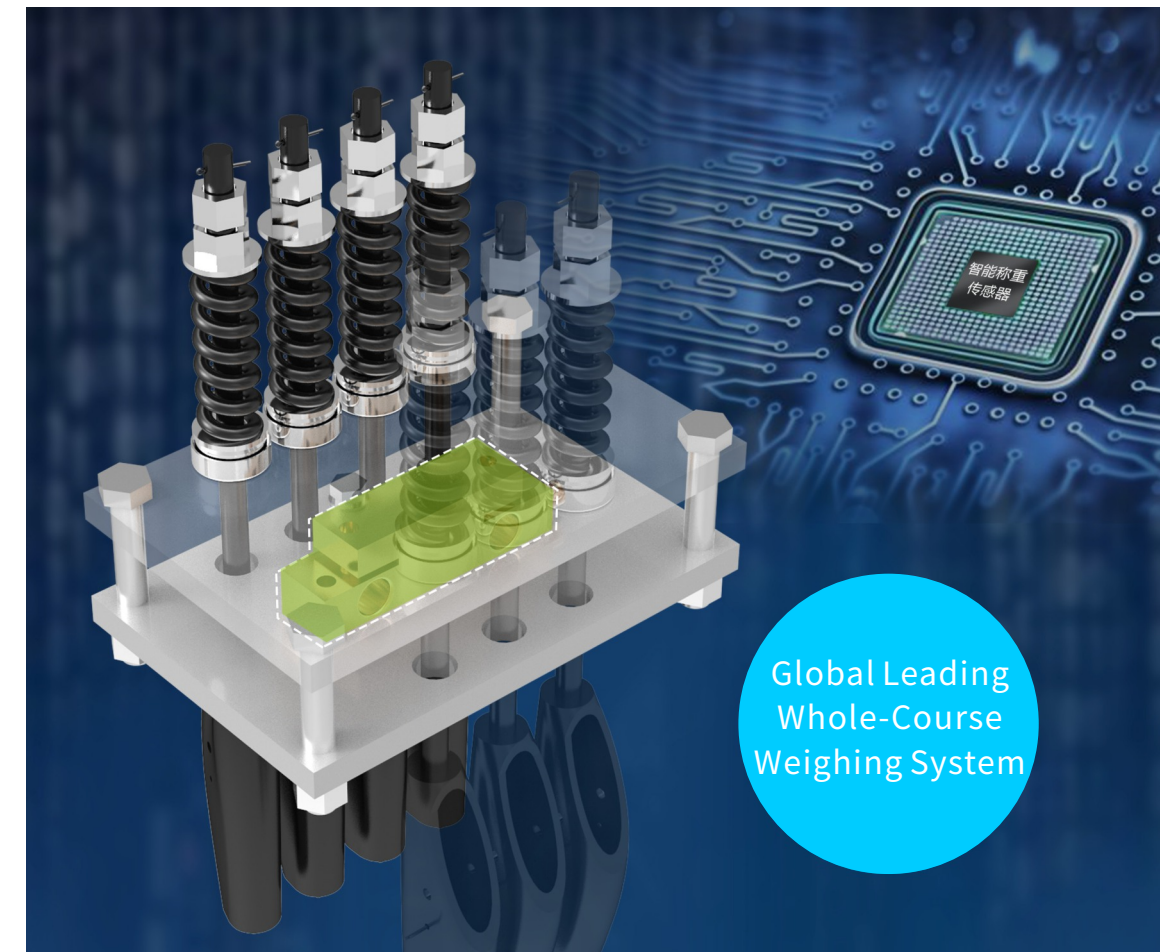



## STURDY AND DURABLE

### Durable

- ◆ The car is made of high strength profile and matched with 5mm thick patterned steel plate as the cage floor, which is strong and durable.

### Landing door strength

- ◆ Through the strength test of 45 kg soft pendulum impact landing door from 1100 mm (800 mm required by national standard), it can effectively deal with reckless impact.

5mm

Patterned steel plate thickness

1100mm

Strength test of 45 kg soft pendulum for landing door

## ACCURATE AND STABLE

- ◆ The new generation of frequency conversion technology and permanent magnet synchronous tractor can effectively reduce the vibration and noise during the operation of elevator, improve the efficiency of cargo transportation and reduce the power consumption of operation.
- ◆ High reliability and high precision electronic flat switch can achieve accurate flat to facilitate the handling of goods.

## ENERGY SAVING AND LOW CONSUMPTION



### German TÜV Energy Efficiency Class A Certification

After the German TuV energy efficiency testing and evaluation, IFE products obtained VDI 4707, PART1 highest grade A energy saving certification. At the same time, we also won a large number of high-quality customers in the Chinese market and industry appreciation.



### Meet EU EMC Standard and CE Certification

The product has passed the authoritative CE certification and meets the EMC and environmental protection standards. The low radiation and no electromagnetic pollution can give passengers green safety protection.

### AGV Intelligent Interconnection Function (Optional)

- ◆ It can customize the interconnected communication between AGV intelligent car and elevator, exchange data with each other, guide AGV intelligent car to take the elevator up and down automatically, and realize cargo handling and intelligent chemical plant across floors. (For providing interface and protocol, please consult operating center.)

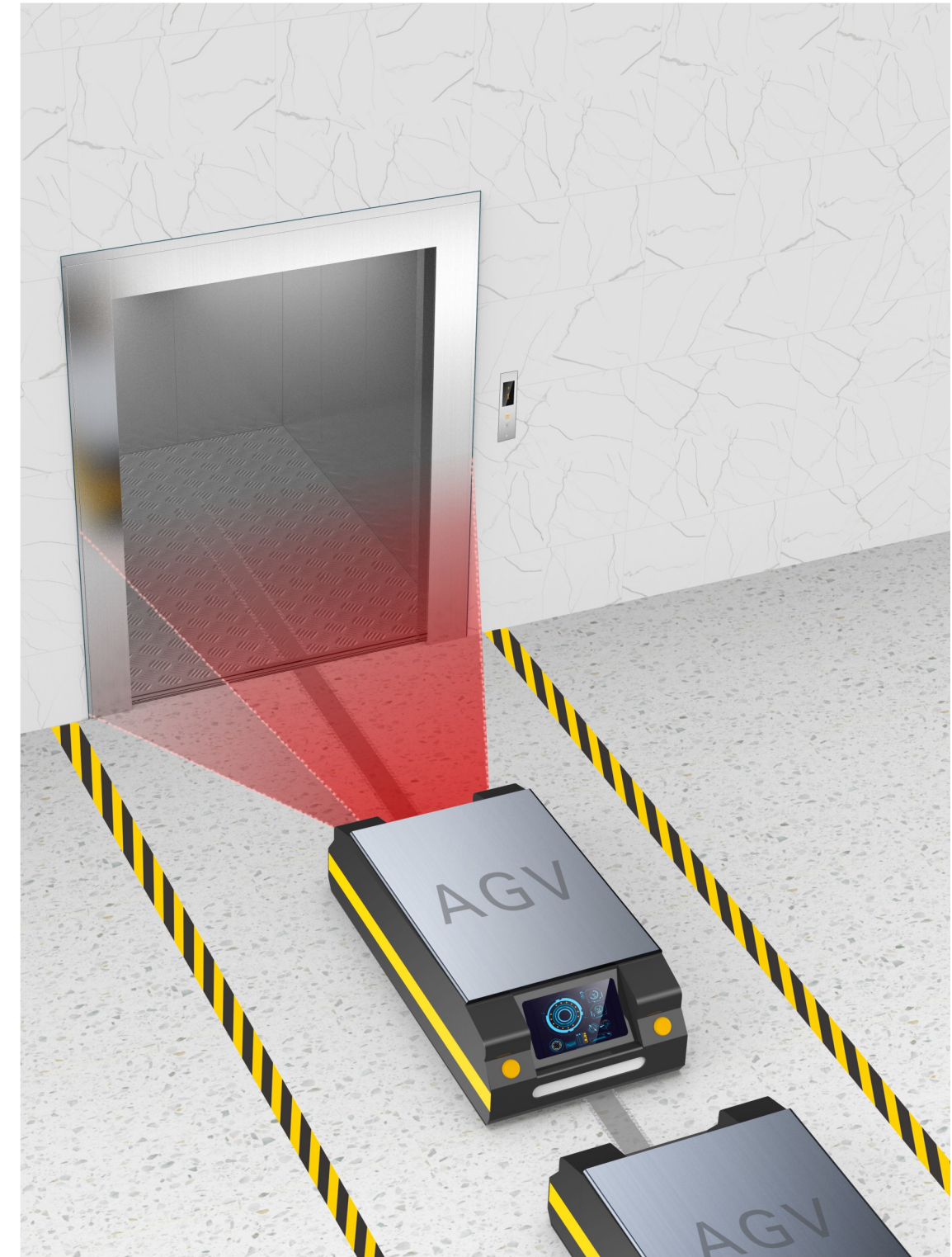





## ATLAS Small Machine Room Cargo Elevator Series Selection Table

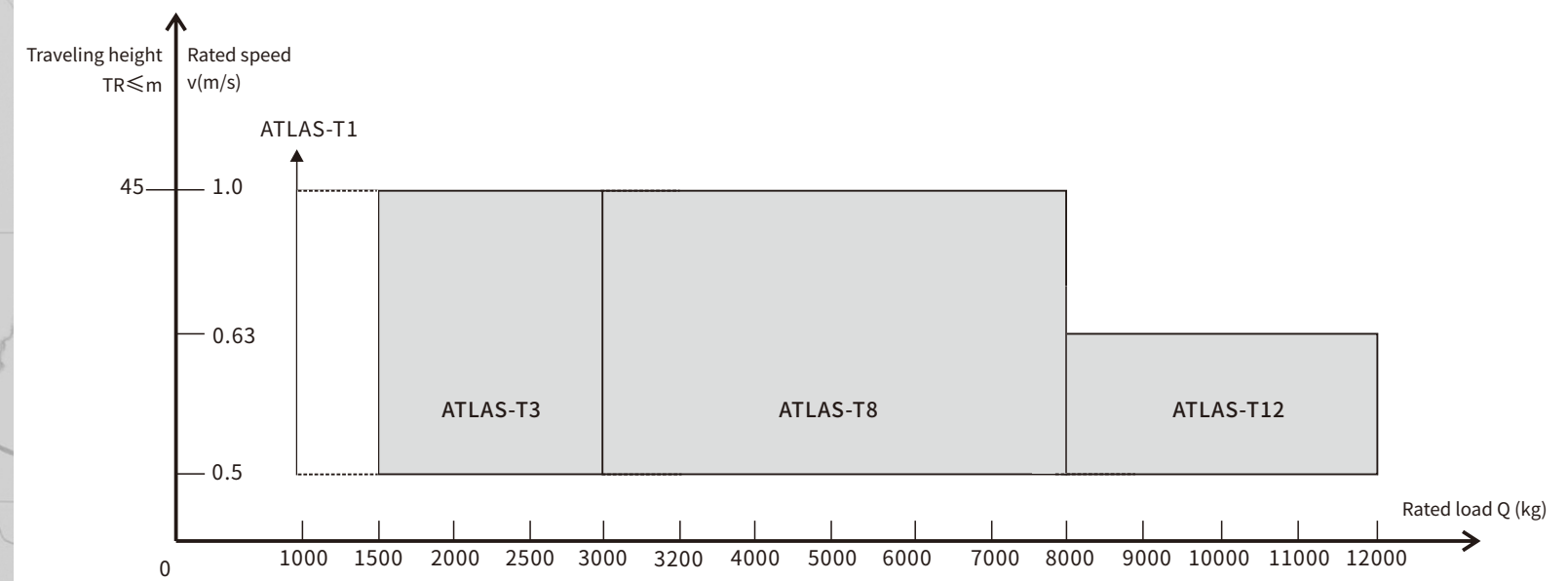

Market



Hotel



Factory



Public transportation

Model and application scope	General cargo elevator ATLAS-T1	Suitable for small manual forklift truck ATLAS-T3	Suitable for small motor forklift truck ATLAS-T8	Suitable for medium and large motor forklift truck ATLAS-T12
Rated load Q (kg)	1000	1500 2000 2500 3000	3200 4000 5000 6000 7000 8000	9000 10000 11000 12000
Rated speed v(m/s)	0.5 1.0	0.5 1.0	0.5 1.0	0.5 0.63
Maximum traveling height TR ≤ m	45	45	45	45



## ATLAS Machine Roomless Cargo Elevator Series Selection Table

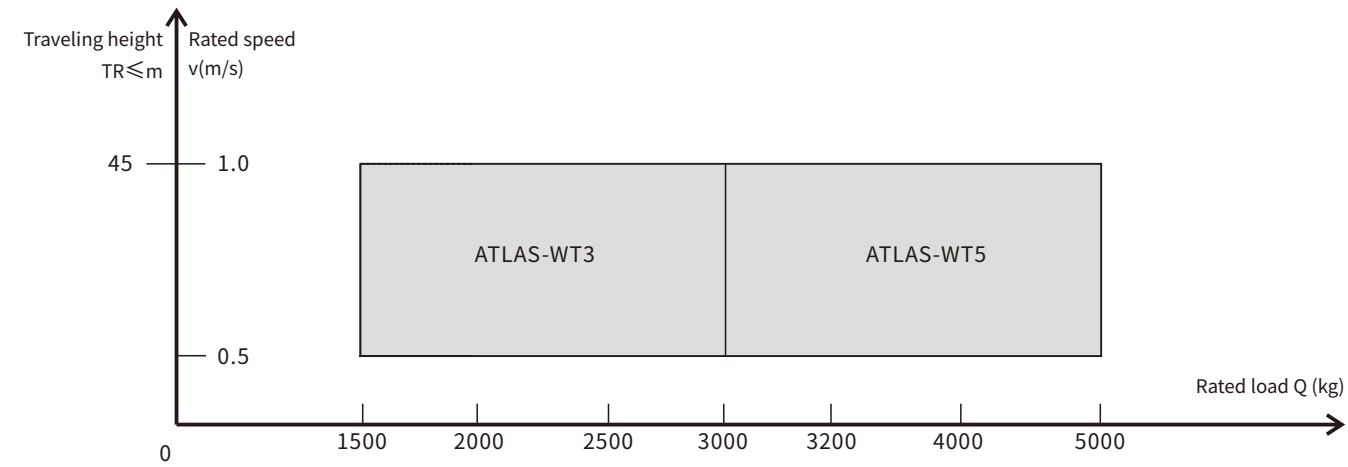

Market



Hotel



Factory



Public transportation



Suitable for small manual  
forklift truck

**ATLAS-WT3**



Suitable for small motor  
forklift truck

**ATLAS-WT5**

Model and application scope	Suitable for small manual forklift truck <b>ATLAS-WT3</b>	Suitable for small motor forklift truck <b>ATLAS-WT5</b>
Rated load Q (kg)	1500 2000 2500 3000	3200 4000 5000
Rated speed v(m/s)	0.5 1.0	0.5 1.0
Maximum traveling height TR ≤ m	45	45

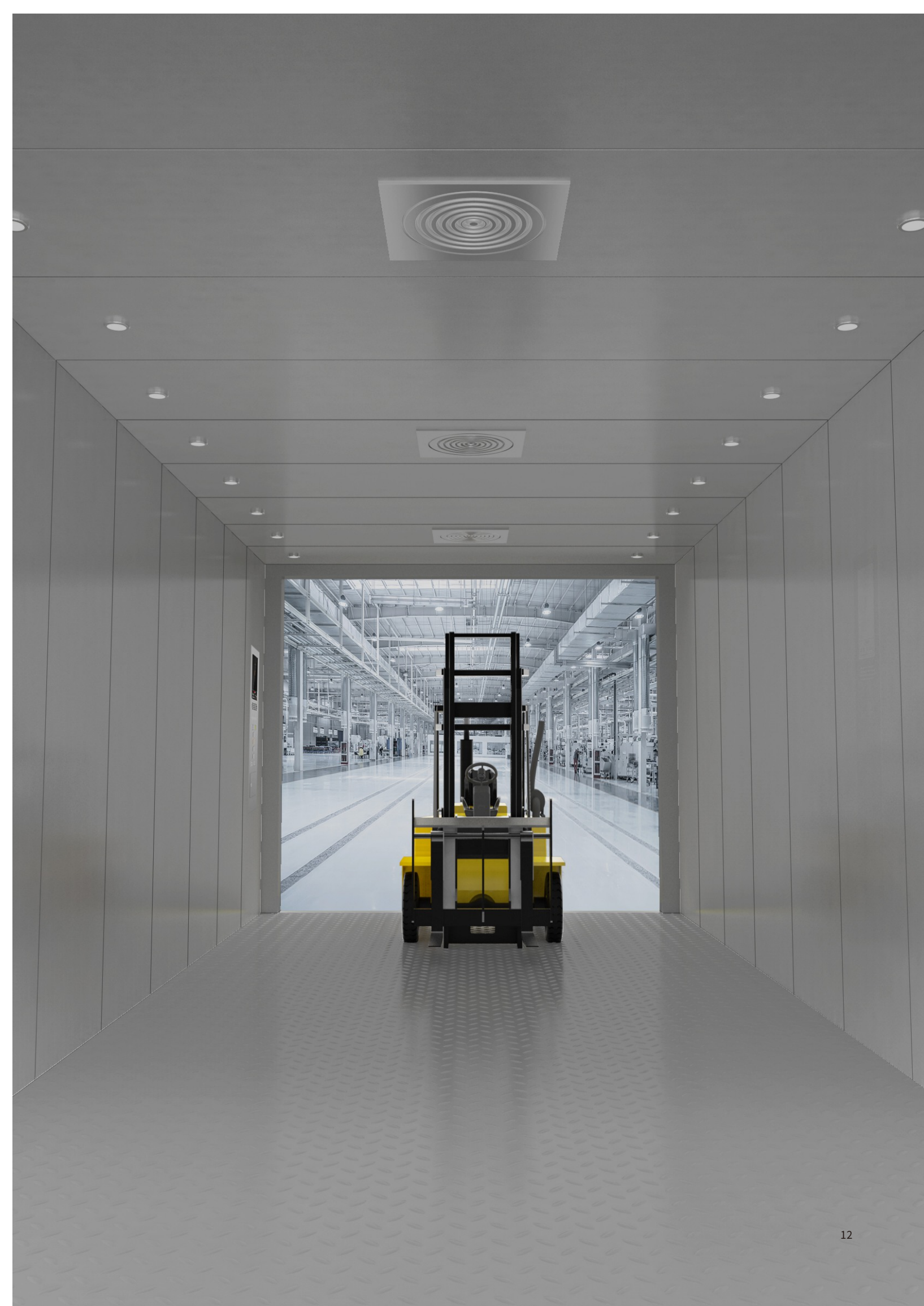





## FPA AUTOMOBILE ELEVATOR SPECIAL FUNCTION

### Automobile Limiting Device in Car

In the elevator car, fixed limit devices are installed on the left and right sides of the floor, and retractable limit devices are installed near the front door to prevent the car from scratching to the elevator.

### Landing floor call elevator device

In the waiting area before the automobile enters the elevator, the driver can operate the button without getting off the elevator by setting up an independent landing door calling device, which makes the elevator more convenient and fast.

### Linkage with Parking Equipment in Parking lot ( Customization)

**Mode A: Linking with the intelligent identification system of parking entrance and exit, no manual operation during the whole process.**

When the automobile enters the entrance of the parking lot, the elevator receives the signal of the parking lot system and automatically runs to the floor to open the door and wait. When the car enters the elevator car, the elevator closes the door and automatically registers the floor signal for the purpose of the automobile (the designated floor signal sent by the parking lot system). When the automobile leaves the parking position, the intelligent identification system of the parking floor sends the signal to the elevator and call, the elevator in advance to the parking floor to open the door and wait, and automatically register the signal of the exit building.

**Mode B: Linking with Intelligent Parking Equipment to Realize Auto Parking and Automobile Retrieval**

When the automobile reaches the designated area and passengers swipe their cards, intelligent parking equipment automatically carries the automobile to the corresponding parking position to realize auto-parking.

When the passengers swipe their cards to pick up the automobile, the intelligent parking equipment automatically carries the automobile to the designated area to realize the automatic pick-up.

## FPA Automobile Elevator Series Selection Table

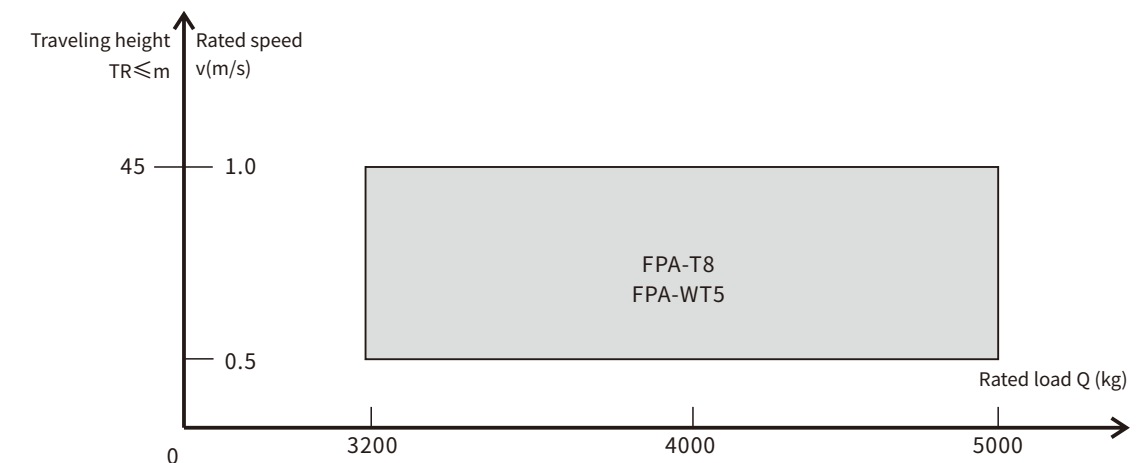

Auto 4S shop



Market



Public transportation

Model and application scope	Small machine room automobile elevator	Machine roomless automobile elevator
	FPA-T8	FPA-WT5
Rated load Q (kg)	3200	3200
	4000	4000
	5000	5000
Rated speed v(m/s)	0.5	0.5
	1.0	1.0
Maximum traveling height TR ≤ m	45	45



# DECORATION

---

## CAR DECORATION STANDARD



### CAR180

Control Box: COP100 Hairline Stainless Steel

Car Door: LDP110 Painted Steel-Matt Grey (Side Open)

LDP120 Painted Steel-Matt Grey (Medium Double Fold)

Lighting: LED Lamp

Floor: F300 Pattern Steel Panel

## CAR DECORATION OPTIONAL



### CAR280

Control box: COP100 Hairline Stainless Steel

Car door: LDP310 Hairline Stainless Steel (Side Opening)

LDP320 Hairline Stainless Steel (Medium Double Fold)

Lighting: LED Lamp

Floor: F300 Pattern Steel Panel



# DECORATION

Hairline stainless steel panel is very durable; Dot matrix LED display is cleaner and its operation panel is more user-friendly.

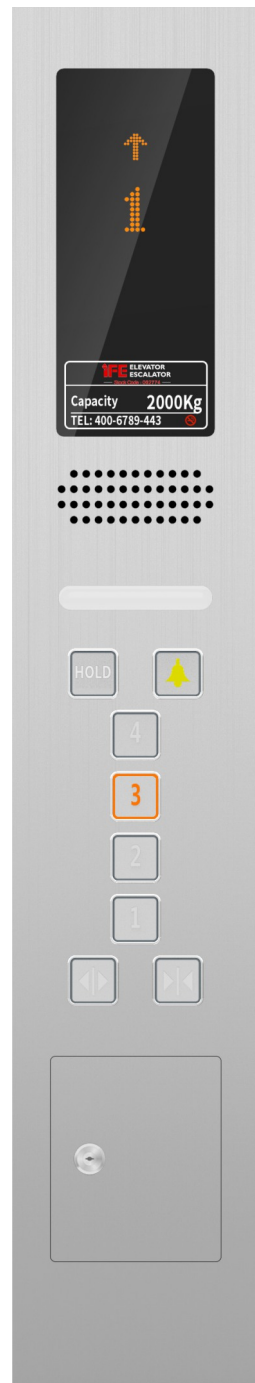

**COP100 (Standard Configuration)**

Panel: Hairline Stainless Steel  
Display: Orange Dot Matrix



First Floor Effect



Other Floor Effect

## HOP100(Standard Configuration)

Panel: Hairline Stainless Steel  
Display: Orange Dot Matrix

## Floor Material Selection

The floor is made of high strength profiles, which are durable against abrasion, pressure and corrosion.

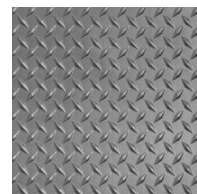

Pattern Steel Panel F300  
(Standard)

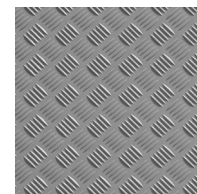

Patterned Aluminum Panel F400  
(Optional)

# LANDING DOOR SERIES

Multiple landing door selection perfectly adapted to a variety of architectural styles and use scenarios.



**Standard Configuration**

Door Jamb: LDJ110 Painted Steel-Matt Grey  
Landing Door:  
LDP110 Painted Steel-Matt Grey (Side Opening)  
LDP120 Painted Steel-Matt Grey (Medium Double Fold)  
Floor Sill: Formed Steel



**Optional Configuration**

Door Jamb: LDJ120 Hairline Stainless Steel  
Landing Door:  
LDP Hairline Stainless Steel(Side Opening)  
LDP320 Hairline Stainless Steel(Medium Double Fold)  
Floor sill: Formed Steel

## Door Opening Method

Provide a variety of methods to open doors to meet the needs of civil engineering and daily use.



Side Opening



Medium Double Fold

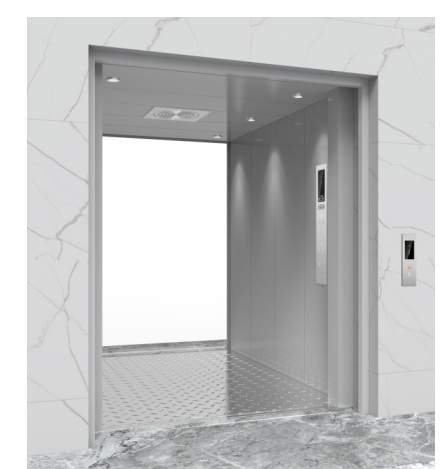

Dual Opening



# ATLAS CARGO ELEVATOR SERIES FUNCTION TABLE

## Basic Function

### Operation Functions

01	Full Selective Collection	Collect at the calling signals to answer selectively based on the signal control system
02	Full Load By-pass	No response to the hall calling signal when the lift is at full load in automatic mode, but only answers the car calling signal
03	Car Call Reset	Double click the COP button to cancel the wrong command to achieve car call reset
04	Door Open/Close Button	Micro buttons on the cop to control the door open/close so that passengers could handle the open/ close timing flexibly
05	Door Open/Close Button Light	Door open/close button light lights up to indicate the successful answer
06	Resume Operation in Power Supply	When the position signal is failed to retain or not sure about the elevator position after a power failure, the elevator would go to the end floor to re-position and be back to normal running
07	Automatic Home Landing	The elevator would be back to base floor to stand by under automatic condition if there is calling command within the setting time
08	Door Reopening by Landing Call	Push the HOP button same as the elevator going direction when the door is closing, then the door will reopen
09	Torque Compensation in Start	The system will calculate as per the load in elevator and optimize the torque compensation to give more comfort when the elevator starts
10	Direct Landing Technology	Micro-computer controller automatically calculates the optimum speed profile according to the target floor distance and directly lands without crawling

### Safety Functions

11	Safety Loop Protection	When the elevator falls, elevator microcomputer control system will report the fault code based on the preset fault code to bring convenience to maintenance staff
12	Absent or Mistaken Epsilon Phase Device	When the power supply is off phase or phase sequence is wrong, the system safety circuit will be disconnected and the elevator will stop running
13	Overload Protection	When the car is loaded beyond the rated load, overloading buzzer will sound to alert. At this moment, the door is not closing and the elevators is not working
14	Safety Curtain with Multiple Light Beams	The system forms a dense infrared cross light curtain at the elevator door, which can make a sharp response to people or objects entering its detection area, so as to protect passengers to enter and exit the door safely.
15	Door Reverse	The door is subjected to a reverse resistance exceeding the preset torque value when it is closing, the elevator will reopen
16	Door Interlock Protection	Only when the hall door and car door are normally closed and the control system detects and judges that they are normal, can the elevator operate normally
17	Landing Zone Guard	For safety reason, the car door cannot open in the non-leveling area
18	Downward Over Speed Protection	When the downward running speed of the elevator exceeds the predetermined speed, the speed limiter will be started to disconnect the electrical safety circuit. At the same time, the safety clamp will start to stop the elevator car on the guide rail
19	Upward Over Speed Protection	When the upward running speed of the elevator exceeds the preset speed, the speed limiter is started to disconnect the electrical safety circuit. At the same time, the traction machine lock is started to make the elevator stop reliably
20	Reversal Movement Guard	When the system detects that the actual direction of operation is inconsistent with the given direction, it will immediately stop and give an alarm
21	Brake Guard	Brake relay signals are being monitored in the entire process. When the brake relay finds the actual states is inconsistent with the specified command, the system will stop the elevator operating
22	Contractor Non-releasing Protection	No matter the elevator is running to the terminal station and the operating speed is not reduced to a preset value, the system will be forced to slow down to ensure the safe operation of elevator
23	Speed Limited Switching in Terminator	When the elevator runs to the terminal floor and the speed does not reduce to the preset value, the system will force the deceleration to protect the safe operation of the elevator
24	Buffer Safety Protection	The cushioning of the car or the weight is activated when the elevator for some reason runs through the terminal floor. At the same time, the system safety loop will be cut off
25	Microcomputer Self-check Protection	When the elevator is powered off, the input and output points of the controller will be scanned before starting to use. After verifying the data, if any abnormality is found, the elevator will stop operation
26	Anti-locked-rotor Feature of Motor	When the elevator is started, the traction machine will not turn due to mechanical obstruction. If the preset time is exceeded, the system will stop the elevator operation
27	Fault Storage	The computer will store the elevator accident records for the elevator manufacturers and maintenance personnel to carry out statistical analysis of the elevator running state
28	Star Closure Method	When the brake fails and leads to an unintended movement of elevator, the three-phase winding of the permanent magnetic synchronous motor will be in short circuit and turn to power generation state. It drives the elevator running at the speed of 0.1m/s and eliminates the risk of high-speed slip to ensure the safety of passengers
29	Hoisting Rope Anti-loose Detection	The hoisting rope is under real-time detection during the elevator operation. When single or multiple hoisting ropes are detected to be stack relaxation, the elevator will stop running immediately
30	Electronic Weighting	It accurately measures the weight of each floor and provides signals to the control system to achieve anti-disturbance, full load driving, overload protection and other functions
31	Brake Monitoring Device	It detects whether the action of the lock on the left and right sides is consistent and reliable. If it is inconsistent or unreliable, the control system will automatically report the lock detection fault to stop the operation of the main machine and prevent the lock failure of the tractor
32	UCMP	When the car leaves the floor station without instructions (excluding the movement caused by loading and unloading) in the unlocked area and under the open state, UCMP protection device will detect the danger and send out a signal to forcibly stop the elevator car to protect the safety of passengers

33	Landing Door& Car Door Bypass Devices	In order to maintain the contact of the landing door and the car door (including the door lock contact), a bypass device is provided on the control cabinet. When bypassing the device, the contacts of the landing door and the car door cannot be bypassed at the same time. In the bypass state, only the operation or emergency electric operation can be repaired, and the sounding device and the car bottom setting flashing light are set on the car to give an alarm promptly
34	Door Circuit Detection	When the car is in the unlocking area, and the door is opened and the door lock is released, it can monitor and check the electrical safety device for the closed position of the door, check the electrical safety device for the locked position of the lock device for the floor lock and the correct action of the monitoring signal. If a fault is detected, the elevator will not operate normally

### Special Operation

35	Attendant Operation	By opening the switch in COP, the elevator will be turned into the attendant operation state, which can manage the number of passengers in the car, the response to the elevator call outside the hall, opening and closing, etc
36	By-pass Switch	After entering the driver operation state, By-pass Switch is pressed before starting. In the next operation process of the elevator, the elevator does not respond to the external call, but directly drives to the floor registered by instructions in the car
37	Buzzer	When the elevator is the drive operation state, buzzer will sound to alert the drives that someone is calling if it is registered by external call
38	Independent Service	It is a special operation function. At this time, the elevator no longer answers the call signal outside the hall, but can only be opened and closed manually
39	Main Floor Setting	According to site requirements by setting the main station based on basic parameters, the elevator will return to the preset floor when it exceeds a specified timing without any operations
40	Firefighting Floor Settings	According to site requirements by setting fire man service floor based on the basic parameters, the elevator will land to the preset floor when inputting the fireman service signal
41	Inspection Operation	By pressing the upper, lower and public buttons on the roof inspection box, the elevator can run at a low speed in the selected direction. This open and close button controls the elevator to open and close, making the maintenance safer and faster
42	Flexible Car Park Set	Clients can decide the elevator stops or not on a specified floor
43	Open the door to maintain the delay function	When the delay button works, the delay will last for a long time (the delay time can be set), and the elevator will close automatically

### Human Machine Interface

44	Floor Mark Flexible Set	The type of words special floors can be customized regarding to the requirements
45	Arrival Chime	Arrival chime will sound when the elevator is arriving at a certain floor

### Emergency Functions

46	Car Alert Button	Passengers can inform the outside in time by pressing the car alert button under special circumstance
47	Emergency Lighting inside the Car	Emergency light inside the car can be used during power outage
48	Intercom Device	Intercom device can give realization of 5 party conversations among car, pit, car top, machine room and monitoring center. Clients are supposed to supply a wire form monitoring center to the first floor. Specifications: 4X0.75mm <sup>2</sup> ( distance no more than 1800 meters)
49	Fire Emergency	Elevator will cancel all calling signals and go straight to the fire man service floor after receiving the fire signal. It will also keep the door opening and wait for the operation of fire man. It will return to normal use when the fire signal is canceled
50	Fire Emergency Landing Feedback	After the elevator receives the fire signal and automatically returns to the fire floor, the system will give a dry contact signal to the management center, indicating that the elevator has received the fire signal and has returned to the fire floor to be operated by the firefighters
51	Emergency Rescue	When the safety gear, oil buffer, upper limit switch, lower limit switch and governor take action, operating the emergency rescue function in the control panel makes the elevator run slowly in order to swiftly save people

### Energy Saving Function

52	Parking Service	The parking stop switch. When the key switch is set in the designated floor, the elevator will return to the locked elevator floor after answering all the instructions, and the door will be closed to enter the state of energy-saving machine
53	Energy Standby	In the absence of any operating instructions, the elevator will enter automatic turn on/off mode within the preset timing and closing door, turning off the lights and fans inside the car

### Optional Function

01	Voice Announcement	Voice announcement will sound when the elevator arriving at station
02	Auto Rescue Device	When the power is suddenly cut off during normal operation of the elevator, the device will act quickly and drive the elevator to move to the nearest floor at a low speed to open the door and respect passengers
03	Door Safety Contact Pate Protection	When the elevator is closed, if the passenger touches the safety contact plate, the door will stop closing and open the door in reverse direction to prevent the passenger from getting caught
04	Collision Avoidance Board	An anti-collision board with a height of 300 mm is added to the lower part of the car wall to prevent the car wall from being damaged by forklift trucks, etc
05	Landing Door Anti-collision Device	Install anti-angle iron at landing door to prevent the door jamb from being hit
06	Sub-COP	It is convenient for passengers to choose floor in the cabin
07	AGV Intelligent Interconnection Function	The Internet communication between AGV smart car and elevator can be customized. They exchange data with each other and guide the AGV smart car to automatically take the elevator up and down. Finally, the cross-floor handling and intelligent factory can be realized



# FPA AUTOMOBILE ELEVATOR SERIES FUNCTION TABLE

## Basic Function

### Operation Functions

01	Full Selective Collection	Collect at the calling signals to answer selectively based on the signal control system
02	Full Load By-pass	No response to the hall calling signal when the lift is at full load in automatic mode, but only answers the car calling signal
03	Car Call Reset	Double click the COP button to cancel the wrong command to achieve car call reset
04	Door Open/Close Button	Micro buttons on the cop to control the door open/close so that passengers could handle the open/ close timing flexibly
05	Door Open/Close Button Light	Door open/close button light lights up to indicate the successful answer
06	Resume Operation in Power Supply	When the position signal is failed to retain or not sure about the elevator position after a power failure, the elevator would go to the end floor to re-position and be back to normal running
07	Automatic Home Landing	The elevator would be back to base floor to stand by under automatic condition if there is calling command within the setting time
08	Door Reopening by Landing Call	Push the HOP button same as the elevator going direction when the door is closing, then the door will reopen
09	Torque Compensation in Start	The system will calculate as per the load in elevator and optimize the torque compensation to give more comfort when the elevator starts
10	Direct Landing Technology	Micro-computer controller automatically calculates the optimum speed profile according to the target floor distance and directly lands without crawling

### Safety Functions

11	Safety Loop Protection	When the elevator falls, elevator microcomputer control system will report the fault code based on the preset fault code to bring convenience to maintenance staff
12	Absent or Mistaken Epsilon Phase Device	When the power supply is off phase or phase sequence is wrong, the system safety circuit will be disconnected and the elevator will stop running
13	Overload Protection	When the car is loaded beyond the rated load, overloading buzzer will sound to alert. At this moment, the door is not closing and the elevators is not working
14	Safety Curtain with Multiple Light Beams	The system forms a dense infrared cross light curtain at the elevator door, which can make a sharp response to people or objects entering its detection area, so as to protect passengers to enter and exit the door safely.
15	Door Reverse	The door is subjected to a reverse resistance exceeding the preset torque value when it is closing, the elevator will reopen
16	Door Interlock Protection	Only when the hall door and car door are normally closed and the control system detects and judges that they are normal, can the elevator operate normally
17	Landing Zone Guard	For safety reason, the car door cannot open in the non-leveling area
18	Downward Over Speed Protection	When the downward running speed of the elevator exceeds the predetermined speed, the speed limiter will be started to disconnect the electrical safety circuit. At the same time, the safety clamp will start to stop the elevator car on the guide rail
19	Upward Over Speed Protection	When the upward running speed of the elevator exceeds the preset speed, the speed limiter is started to disconnect the electrical safety circuit. At the same time, the traction machine lock is started to make the elevator stop reliably
20	Reversal Movement Guard	When the system detects that the actual direction of operation is inconsistent with the given direction, it will immediately stop and give an alarm
21	Brake Guard	Brake relay signals are being monitored in the entire process. When the brake relay finds the actual states is inconsistent with the specified command, the system will stop the elevator operating
22	Contractor Non-releasing Protection	No matter the elevator is running to the terminal station and the operating speed is not reduced to a preset value, the system will be forced to slow down to ensure the safe operation of elevator
23	Speed Limited Switching in Terminator	When the elevator runs to the terminal floor and the speed does not reduce to the preset value, the system will force the deceleration to protect the safe operation of the elevator
24	Buffer Safety Protection	The cushioning of the car or the weight is activated when the elevator for some reason runs through the terminal floor. At the same time, the system safety loop will be cut off
25	Microcomputer Self-check Protection	When the elevator is powered off, the input and output points of the controller will be scanned before starting to use. After verifying the data, if any abnormality is found, the elevator will stop operation
26	Anti-locked-rotor Feature of Motor	When the elevator is started, the traction machine will not turn due to mechanical obstruction. If the preset time is exceeded, the system will stop the elevator operation
27	Fault Storage	The computer will store the elevator accident records for the elevator manufacturers and maintenance personnel to carry out statistical analysis of the elevator running state
28	Star Closure Method	When the brake fails and leads to an unintended movement of elevator, the three-phase winding of the permanent magnetic synchronous motor will be in short circuit and turn to power generation state. It drives the elevator running at the speed of 0.1m/s and eliminates the risk of high-speed slip to ensure the safety of passengers
29	Hoisting Rope Anti-loose Detection	The hoisting rope is under real-time detection during the elevator operation. When single or multiple hoisting ropes are detected to be stack relaxation, the elevator will stop running immediately
30	Electronic Weighting	It accurately measures the weight of each floor and provides signals to the control system to achieve anti-disturbance, full load driving, overload protection and other functions
31	Brake Monitoring Device	It detects whether the action of the lock on the left and right sides is consistent and reliable. If it is inconsistent or unreliable, the control system will automatically report the lock detection fault to stop the operation of the main machine and prevent the lock failure of the tractor
32	UCMP	When the car leaves the floor station without instructions (excluding the movement caused by loading and unloading) in the unlocked area and under the open state, UCMP protection device will detect the danger and send out a signal to forcibly stop the elevator car to protect the safety of passengers

33	Landing Door& Car Door Bypass Devices	In order to maintain the contact of the landing door and the car door (including the door lock contact), a bypass device is provided on the control cabinet. When bypassing the device, the contacts of the landing door and the car door cannot be bypassed at the same time. In the bypass state, only the operation or emergency electric operation can be repaired, and the sounding device and the car bottom setting flashing light are set on the car to give an alarm promptly
34	Door Circuit Detection	When the car is in the unlocking area, and the door is opened and the door lock is released, it can monitor and check the electrical safety device for the closed position of the door, check the electrical safety device for the locked position of the lock device for the floor lock and the correct action of the monitoring signal. If a fault is detected, the elevator will not operate normally

### Special Operation

35	Attendant Operation	By opening the switch in COP, the elevator will be turned into the attendant operation state, which can manage the number of passengers in the car, the response to the elevator call outside the hall, opening and closing, etc
36	By-pass Switch	After entering the driver operation state, By-pass Switch is pressed before starting. In the next operation process of the elevator, the elevator does not respond to the external call, but directly drives to the floor registered by instructions in the car
37	Buzzer	When the elevator is the drive operation state, buzzer will sound to alert the drives that someone is calling if it is registered by external call
38	Independent Service	It is a special operation function. At this time, the elevator no longer answers the call signal outside the hall, but can only be opened and closed manually
39	Main Floor Setting	According to site requirements by setting the main station based on basic parameters, the elevator will return to the preset floor when it exceeds a specified timing without any operations
40	Firefighting Floor Settings	According to site requirements by setting fire man service floor based on the basic parameters, the elevator will land to the preset floor when inputting the fireman service signal
41	Inspection Operation	By pressing the upper, lower and public buttons on the roof inspection box, the elevator can run at a low speed in the selected direction. This open and close button controls the elevator to open and close, making the maintenance safer and faster
42	Flexible Car Park Set	Clients can decide the elevator stops or not on a specified floor
43	Open the door to maintain the delay function	When the delay button works, the delay will last for a long time (the delay time can be set), and the elevator will close automatically

### Human Machine Interface

44	Floor Mark Flexible Set	The type of words special floors can be customized regarding to the requirements
45	Arrival Chime	Arrival chime will sound when the elevator is arriving at a certain floor
46	Dual COP	Dual COPs are arranged in the front left and rear right positions of the car, which is convenient for the operation of selecting the floor after cars' entering

### Emergency Functions

47	Car Alert Button	Passengers can inform the outside in time by pressing the car alert button under special circumstance
48	Emergency Lighting inside the Car	Emergency light inside the car can be used during power outage
49	Intercom Device	Intercom device can give realization of 5 party conversations among car, pit, car top, machine room and monitoring center. Clients are supposed to supply a wire form monitoring center to the first floor. Specifications: 4X0.75mm <sup>2</sup> (distance no more than 1800 meters)
50	Fire Emergency	Elevator will cancel all calling signals and go straight to the fire man service floor after receiving the fire signal. It will also keep the door opening and wait for the operation of fire man. It will return to normal use when the fire signal is canceled
51	Fire Emergency Landing Feedback	After the elevator receives the fire signal and automatically returns to the fire floor, the system will give a dry contact signal to the management center, indicating that the elevator has received the fire signal and has returned to the fire floor to be operated by the firefighters
52	Emergency Rescue	When the safety gear, oil buffer, upper limit switch, lower limit switch and governor take action, operating the emergency rescue function in the control panel makes the elevator run slowly in order to swiftly save people

### Energy Saving Function

53	Parking Service	The parking stop switch. When the key switch is set in the designated floor, the elevator will return to the locked elevator floor after answering all the instructions, and the door will be closed to enter the state of energy-saving machine
54	Energy Standby	In the absence of any operating instructions,, the elevator will enter automatic turn on/off mode within the preset timing and closing door, turning off the lights and fans inside the car

### Optional Function

01	Voice Announcement	Voice announcement will sound when the elevator arriving at station
02	Auto Rescue Device	When the power is suddenly cut off during normal operation of the elevator, the device will act quickly and drive the elevator to move to the nearest floor at a low speed to open the door and respect passengers
03	Door Safety Contact Pate Protection	When the elevator is closed, if the passenger touches the safety contact plate, the door will stop closing and open the door in reverse direction to prevent the passenger from getting caught
04	Collision Avoidance Board	An anti-collision board with a height of 300 mm is added to the lower part of the car wall to prevent the car wall from being damaged by forklift trucks, etc
05	Landing Door Anti-collision Device	Install anti-angle iron at landing door to prevent the door jamb from being hit
06	Remote Control Function	Within the range of 15 meters, the driver can remotely control the escalator without getting off the car
07	Automatic Parking Function	Linking with parking equipment in parking lot to realize automatic parking and pick-up



## ATLAS-T1 HOISTWAY LAYOUT PROFILE

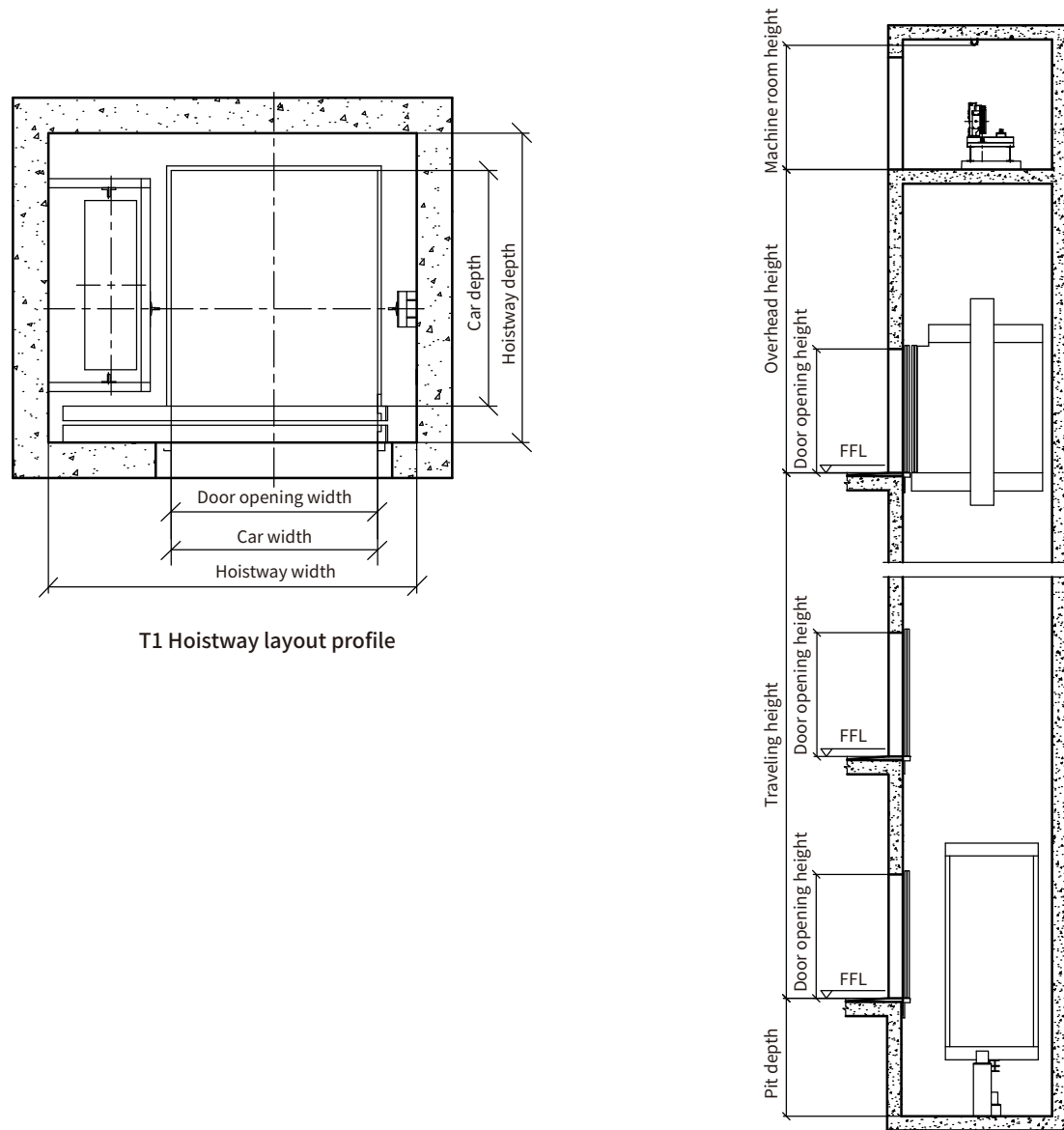

T1 Hoistway layout profile

T1 Hoistway plan

## ATLAS-T1 Technical Parameters Specification

Load (kg)	Rated speed (m/s)	Car Specification (mm) (Width * Depth * Height)	Door opening Size (mm) (Width * Height)	Door opening mode	Hoistway Size (mm) (Width * Depth)		Overhead height (mm)	Pit depth (mm)	Maximum traveling height (m)	Machine room size (mm) (Width * Depth * Height)	Elevator main power supply (RVV Multi-strand soft wire)
					Single opening	dual opening					
1000	0.5	1400*1600*2200	1400*2100	Double fold	2500*2100	2500*2100	4200	1500	≤45	2500*2100*2200	3*6mm <sup>2</sup> +2*6mm <sup>2</sup>
	1.0						4300	1600			

Note: 1. This type of elevator is not suitable for using a forklift to enter the car as a cargo handling device.

## ATLAS-T3 HOISTWAY LAYOUT PROFILE

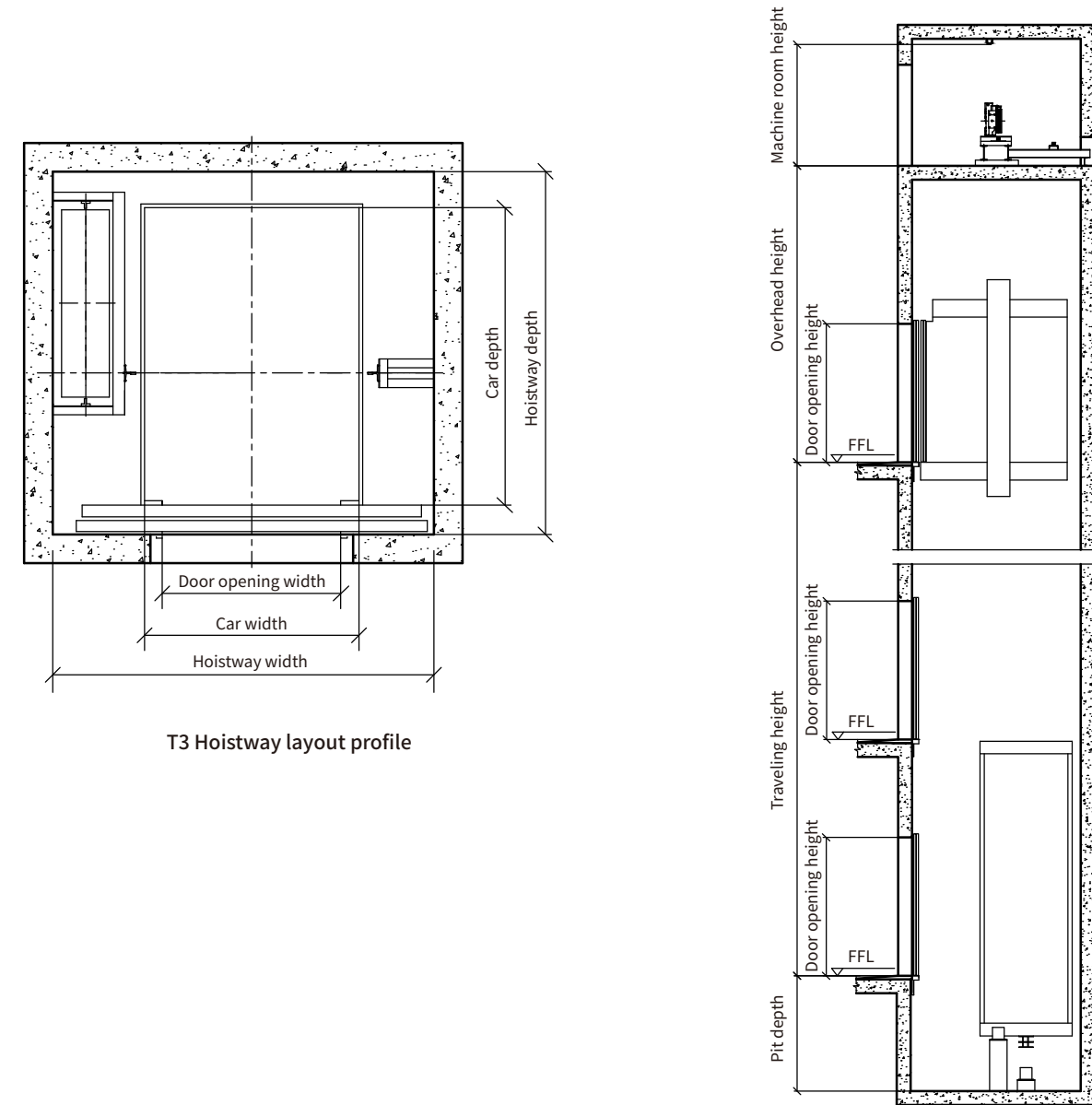

T3 Hoistway layout profile

T3 Hoistway plan

## ATLAS-T3 Technical Parameters Specification

Load (kg)	Rated speed (m/s)	Car Specification (mm) (Width * Depth * Height)	Door opening Size (mm) (Width * Height)	Door opening mode	Hoistway Size (mm) (Width * Depth)		Overhead height (mm)	Pit depth (mm)	Maximum traveling height (m)	Machine room size (mm) (Width * Depth * Height)		Elevator main power supply (RVV Multi-strand soft wire)
					Single opening	dual opening				Single opening	dual opening	
1500	0.5	1600*2100*2200	1400*2100	Double fold	2600*2600	2600*2600	4200	1500	≤45	2600*2600*2200	3*6mm <sup>2</sup> +2*6mm <sup>2</sup>	
	1.0						4300	1600				
2000	0.5	1800*2300*2200	1600*2100	Medium Double Fold	2800*2800	2800*2800	4200	1500	≤45	2800*2800*2200	3*6mm <sup>2</sup> +2*6mm <sup>2</sup>	
	1.0						4300	1600				
2500	0.5	2000*2500*2200	1800*2100	Medium Double Fold	3000*2800	3000*2800	4300	1600	≤45	2800*2800*2200	3*10mm <sup>2</sup> +2*6mm <sup>2</sup>	
	1.0						4400	1600				
3000	0.5	2100*2700*2200	1800*2100	Medium Double Fold	3200*3200	3250*3200	4300	1500	≤45	3200*3000*2200	3*6mm <sup>2</sup> +2*6mm <sup>2</sup>	
	1.0						4400	1600				
3000	0.5	2300*2500*2200	1800*2100	Medium Double Fold	3200*3200	3250*3200	4300	1500	≤45	3300*3200*2200	3*6mm <sup>2</sup> +2*6mm <sup>2</sup>	
	1.0						4400	1600				
3000	0.5	2100*2700*2200	1800*2100	Medium Double Fold	3400*3000	3450*3000	4300	1500	≤45	3400*3000*2200	3*6mm <sup>2</sup> +2*6mm <sup>2</sup>	
	1.0						4400	1600				
3000	0.5	2300*2500*2200	1800*2100	Medium Double Fold	3200*3200	3250*3200	4400	1600	≤45	3200*3200*2200	3*16mm <sup>2</sup> +2*10mm <sup>2</sup>	
	1.0						4400	1600				

Note: 1. This type of elevator is not suitable for using a forklift to enter the car as a cargo handling device.







## ATLAS-WT3 HOISTWAY LAYOUT PROFILE

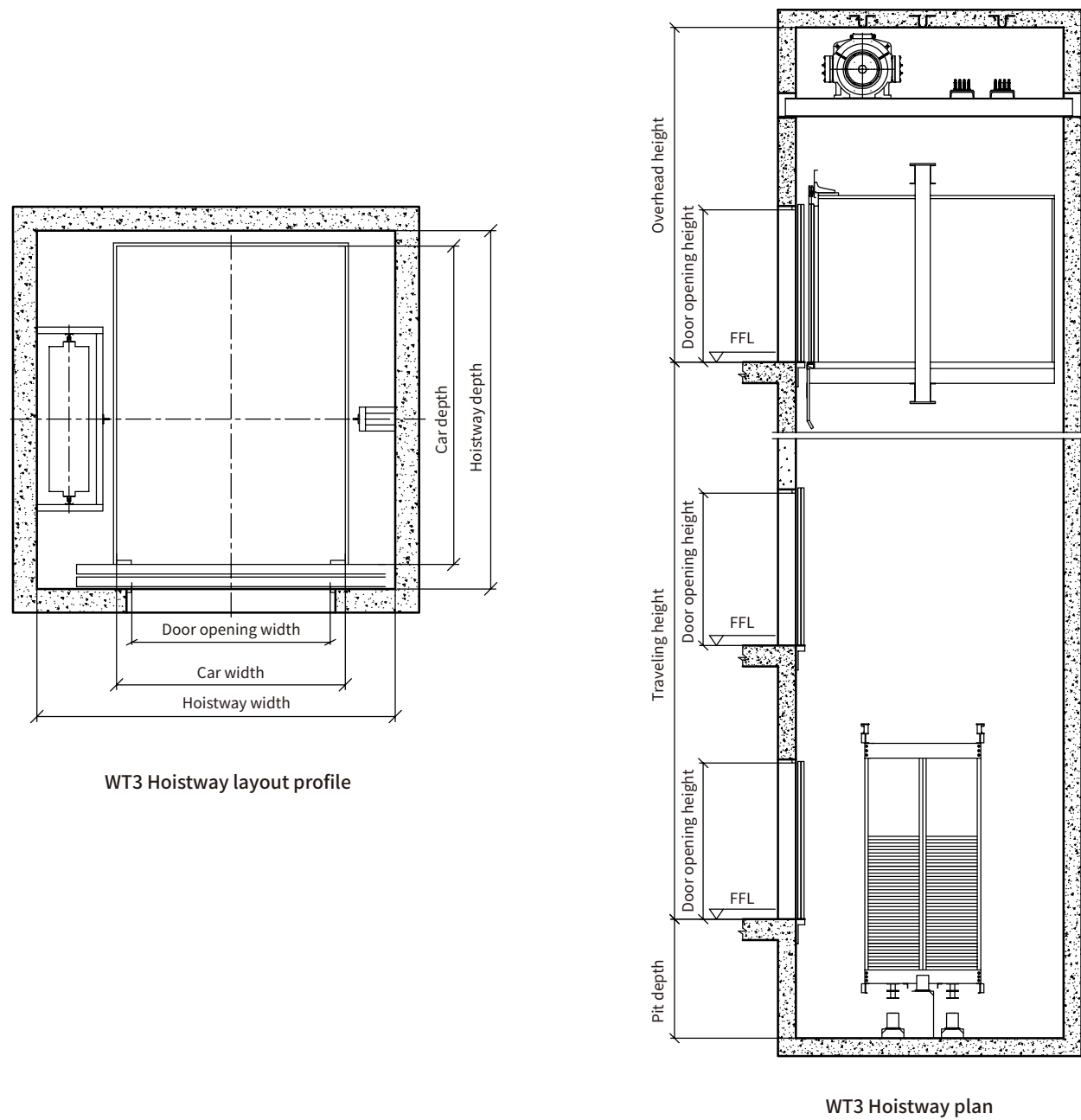

## ATLAS-WT5 HOISTWAY LAYOUT PROFILE

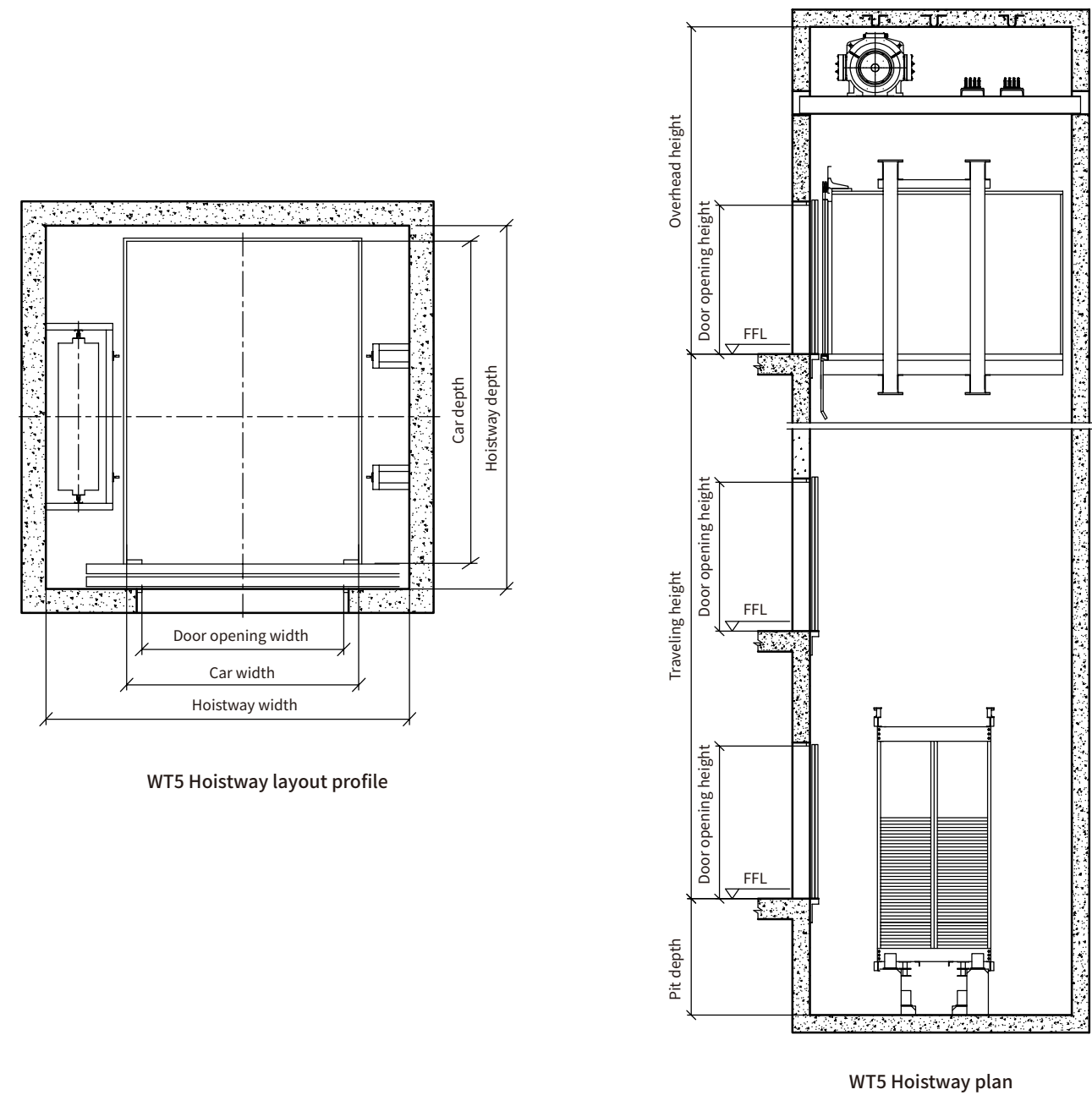

## ATLAS-WT3 Technical Parameters Specification

Load (kg)	Rated speed (m/s)	Car Specification (mm) (Width * Depth * Height)	Door opening Size (mm) (Width * Height)	Door opening mode	Hoistway Size (mm) (Width * Depth)		Overhead height (mm)	Pit depth (mm)	Maximum traveling height (m)	Elevator main power supply (RVV Multi-strand soft wire)
					Single opening	dual opening				
1500	0.5	1600*2100*2200	1400*2100	Double fold	2700*2500	2700*2600	4300	1500	45	3*6mm <sup>2</sup> +2*6mm <sup>2</sup>
	1									
2000	0.5	1800*2300*2200	1600*2100	Double fold	2900*2700	2900*2800	4400	1500	45	3*10mm <sup>2</sup> +2*6mm <sup>2</sup>
	1									
2500	0.5	2000*2500*2200	1800*2100	Medium Double Fold	3300*2900	3300*3000	4400	1500	45	3*6mm <sup>2</sup> +2*6mm <sup>2</sup>
	1									
3000	0.5	2300*2500*2200	2000*2100	Medium Double Fold	3600*2900	3600*3000	4400	1500	45	3*10mm <sup>2</sup> +2*6mm <sup>2</sup>
	1									

## ATLAS-WT5 Technical Parameters Specification

Load (kg)	Rated speed (m/s)	Car Specification (mm) (Width * Depth * Height)	Door opening Size (mm) (Width * Height)	Door opening mode	Hoistway Size (mm) (Width * Depth)		Overhead height (mm)	Pit depth (mm)	Maximum traveling height (m)	Elevator main power supply (RVV Multi-strand soft wire)
					Single opening	dual opening				
3200	0.5	2300*2600*2200	2000*2100	Medium Double Fold	3600*3000	3600*3100	4400	1500	45	3*6mm <sup>2</sup> +2*6mm <sup>2</sup>
	1									
4000	0.5	2300*3200*2200	2000*2100	Medium Double Fold	3600*3600	3600*3700	4500	1700	45	3*10mm <sup>2</sup> +2*6mm <sup>2</sup>
	1									
5000	0.5	2500*3500*2200	2000*2100	Medium Double Fold	3800*3900	3800*4000	4500	1700	45	3*10mm <sup>2</sup> +2*6mm <sup>2</sup>
	1									



## FPA-T8 HOISTWAY LAYOUT PROFILE

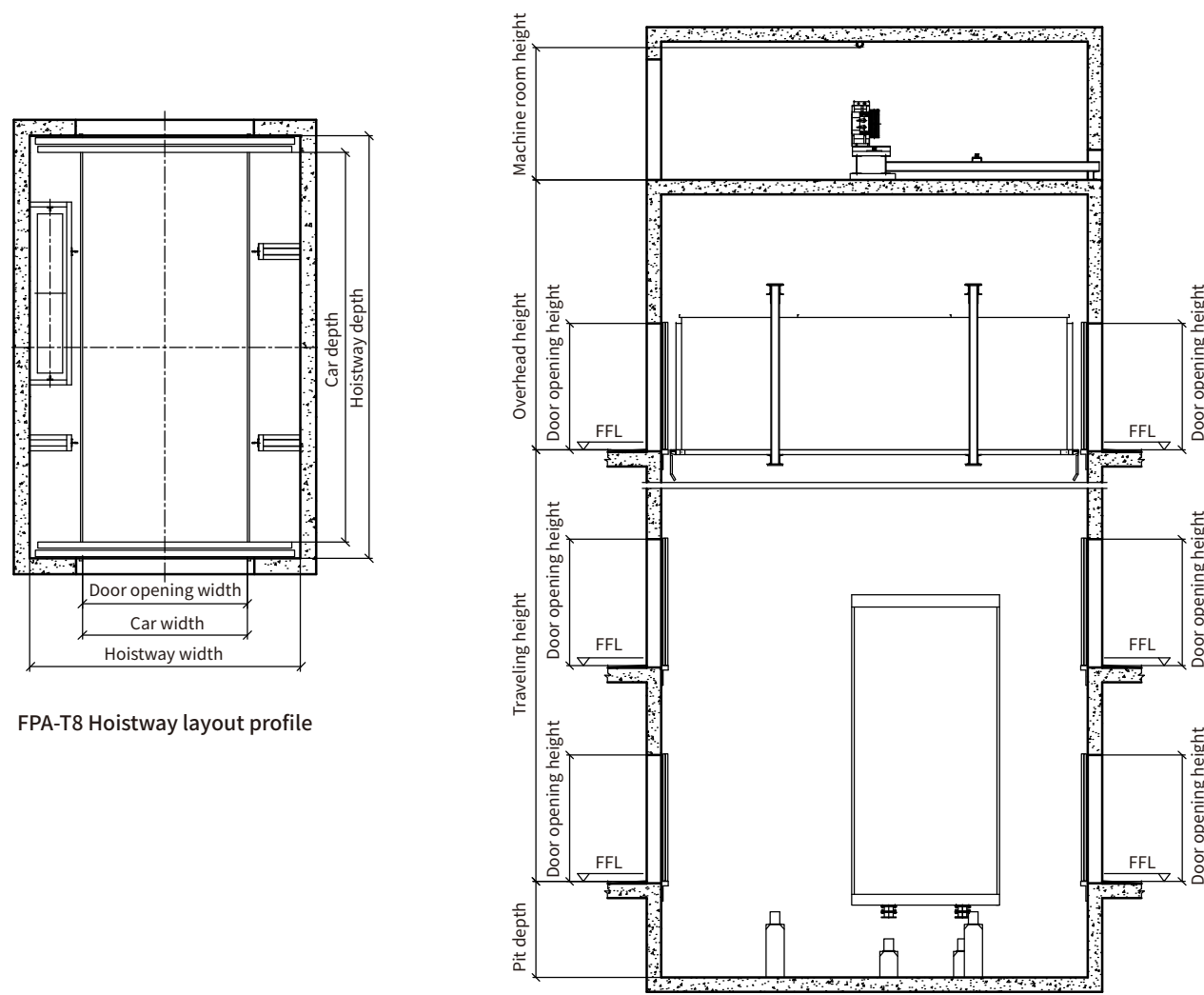

FPA-T8 Hoistway layout profile

FPA-T8 Hoistway plan

## FPA-WT5 HOISTWAY LAYOUT PROFILE

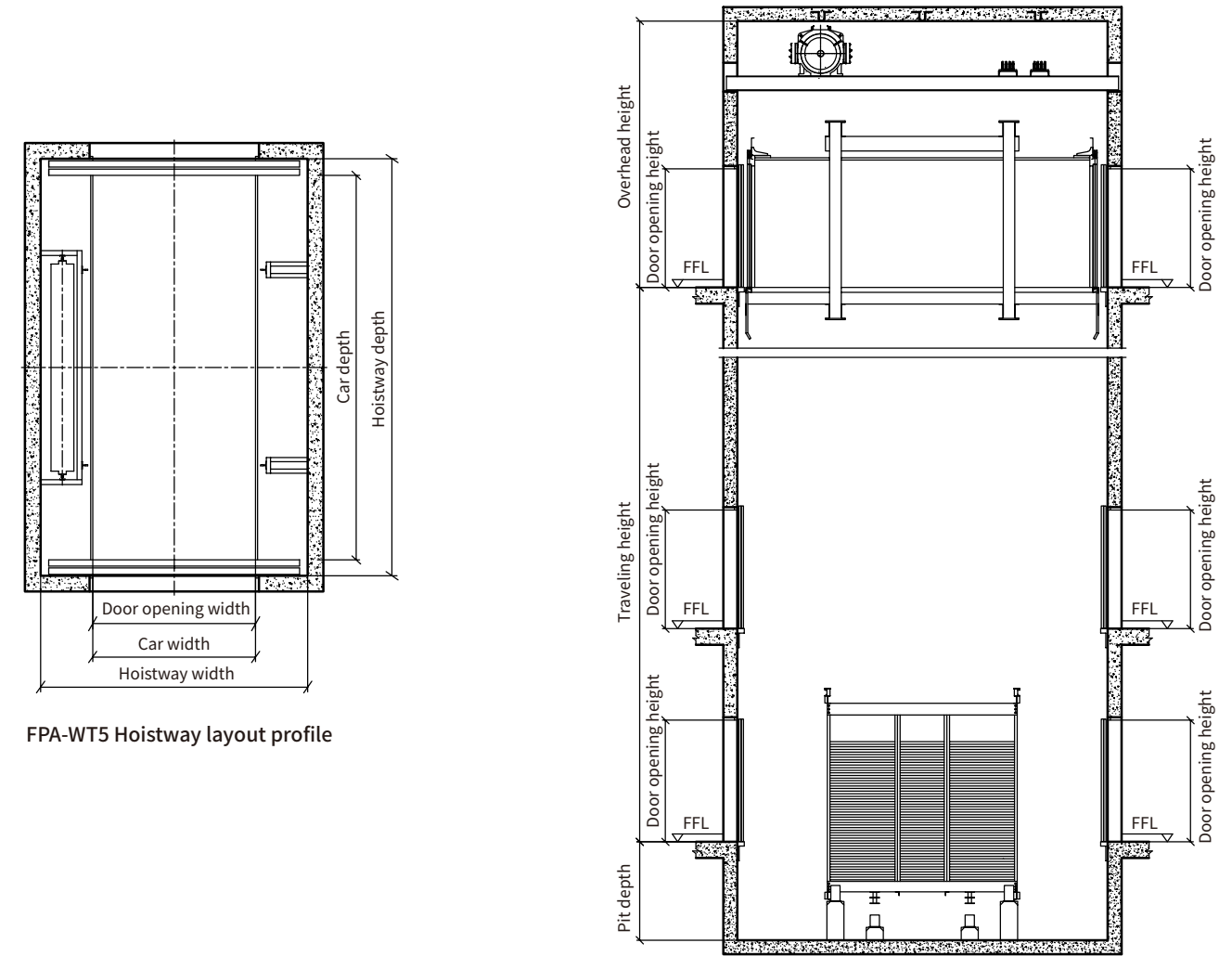

FPA-WT5 Hoistway layout profile

FPA-WT5 Hoistway plan

## FPA-T8 Technical Parameters Specification

Load (kg)	Rated speed (m/s)	Car Specification (mm)(Width * Depth * Height)	Door opening Size(mm) (Width * Height)	Door opening mode	Hoistway Size (mm) (Width * Depth)	Overhead height (mm)	Pit depth (mm)	Maximum traveling height (m)	Machine room size (mm) (Width * Depth * Height)	Elevator main power supply (RVV Multi-strand soft wire)
3200	0.5	2500*5900*2200	2500*2100	Medium Double Fold	4100*6400	4200	1600	45	4100*6400*2200	3*6mm <sup>2</sup> +2*6mm <sup>2</sup>
	4250					3*10mm <sup>2</sup> +2*6mm <sup>2</sup>				
4000	0.5	2600*6300*2200	2600*2100	Medium Double Fold	4200*6800	4200	1600	45	4200*6800*2200	3*6mm <sup>2</sup> +2*6mm <sup>2</sup>
	4250					3*16mm <sup>2</sup> +2*10mm <sup>2</sup>				
5000	0.5	2700*6600*2200	2700*2100	Medium Double Fold	4300*7100	4200	1600	45	4300*7100*2200	3*10mm <sup>2</sup> +2*6mm <sup>2</sup>
	4250					3*25mm <sup>2</sup> +2*16mm <sup>2</sup>				

## FPA-WT5 Technical Parameters Specification

Load (kg)	Rated speed (m/s)	Car Specification (mm)(Width * Depth * Height)	Door opening Size(mm) (Width * Height)	Door opening mode (dual opening)	Hoistway Size (mm) (Width * Depth)	Overhead height (mm)	Pit depth (mm)	Maximum traveling height (m)	Elevator main power supply (RVV Multi-strand soft wire)
3200	0.5	2500*5900*2200	2500*2100	Medium Double Fold	4100*6400	4600	1700	45	3*6mm <sup>2</sup> +2*6mm <sup>2</sup>
	1								3*10mm <sup>2</sup> +2*6mm <sup>2</sup>
4000	0.5	2600*6300*2200	2600*2100	Medium Double Fold	4200*6800	4600	1700	45	3*10mm <sup>2</sup> +2*6mm <sup>2</sup>
	1								3*16mm <sup>2</sup> +2*10mm <sup>2</sup>
5000	0.5	2700*6600*2200	2700*2100	Medium Double Fold	4300*7100	4600	1700	45	3*10mm <sup>2</sup> +2*6mm <sup>2</sup>
	1								3*25mm <sup>2</sup> +2*16mm <sup>2</sup>